

Welcome to
Wellesley Park
 Apartments

Just a short distance from the heart of downtown Salem and the State Capital, our spacious, newly built apartment homes offer you the convenience of nearby shopping and dining. You'll enjoy easy access to public transportation. Nearby Chemeketa Community College is just a short walk or bike ride away.

Your new apartment home was designed to afford you up-to-date kitchen appliances with plenty of storage. Standard features include a full-size washer/dryer, a microwave, and state of the art electronic deadbolt locks.

Choose from our spacious two-bedroom two-bath or three-bedroom two bath apartment homes. We provide professional on-site management and 24-hour emergency maintenance.

Wellesley Park is a non-smoking community.

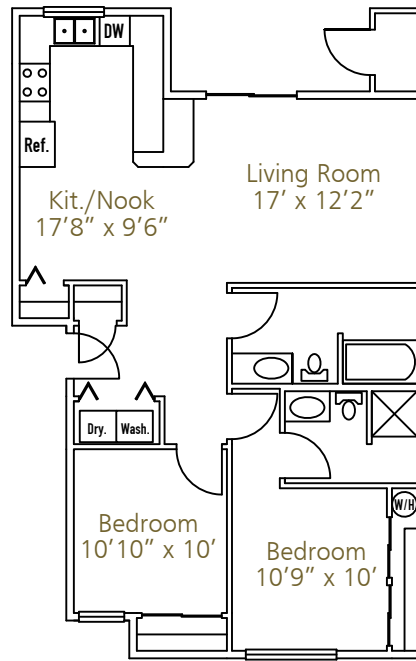
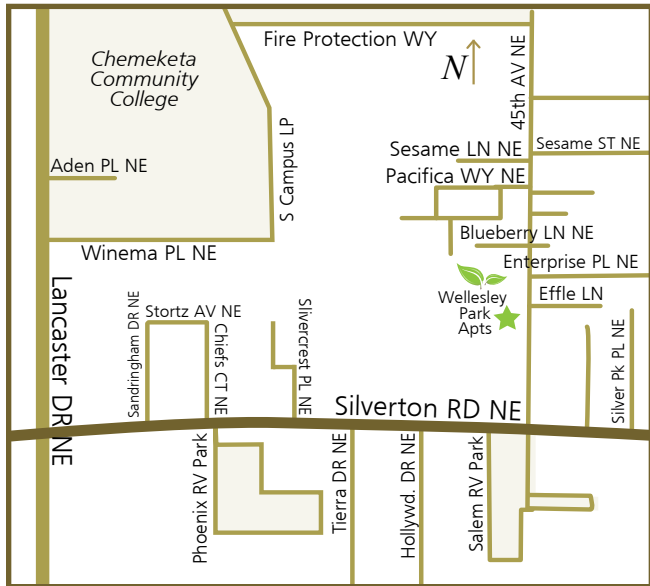

Two Bedroom

Two bedrooms
 two baths
 994 square feet

Pet Friendly!



Units Feature:

- Microwave
- Washer/Dryer
- 18 CF Refrigerator
- Electronic Deadbolt

Amenities include:

- Clubhouse
- 24 Hour On-Site Management and Maintenance Service
- 24 Hour Courtesy Patrol

Three Bedroom

Three bedrooms
 two baths
 1,180 square feet

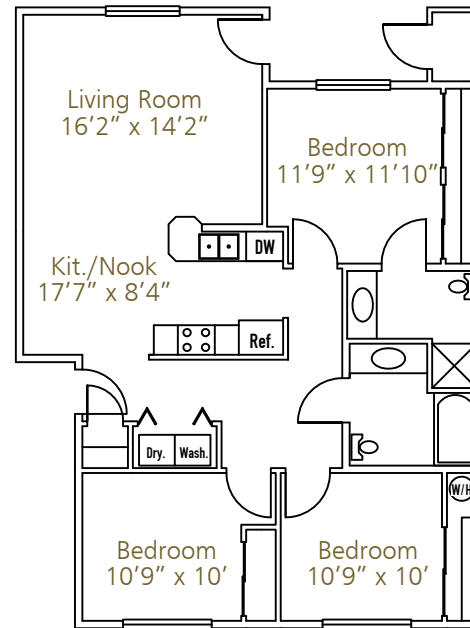

4420 Seaton Lane NE, Salem, OR 97305
 Office: 503 581-3280, Fax: 503 581-3284

